

Palmerston Road Wimbledon, SW19 1PD

£450,000 Leasehold - Share of Freehold



Wonderful garden flat with Share of Freehold in a superb Central Wimbledon Location, comprising: Reception room, double bedroom, stylish modern bathroom, modern fitted kitchen with access to its own private rear garden and side return. Neutrally decorated providing a perfect blank canvass for first time buyers or buy to let investors alike.

PALMERSTON ROAD, SW19

Approx. Gross Internal Floor Area

372 Sq. ft/34.58 Sq. m

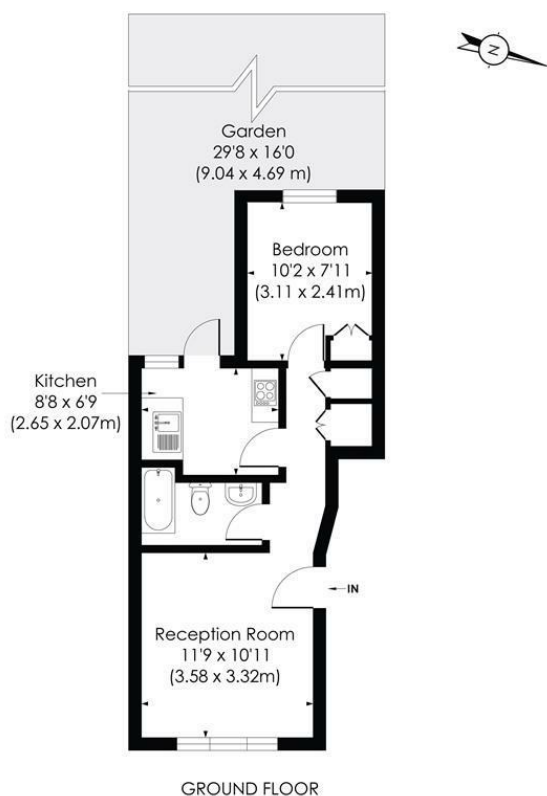

© Pixangle Property Marketing Ltd. info@pixangle.com Tel: 0208 870 2118

pixangle
PROPERTY MARKETING

This floor plan has been prepared for the purpose of illustration only in accordance with the latest RICS code of measuring practice and is not to scale. All measurements and areas are approximate and whilst every effort has been made to ensure the accuracy of the plan contained here, no responsibility is taken for any error, omission or misstatement.

- EPC Rating D
- Council Tax Band C
- Own Private Garden
- Ground floor garden flat
- Double Bedroom
- Modern Bathroom
- fitted kitchen with garden access
- Bright Reception Room
- Central Wimbledon Location
- Share Of Freehold

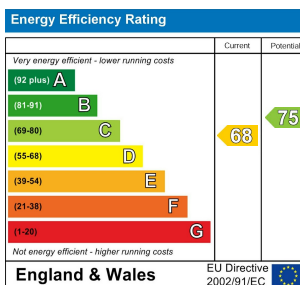

For Free Mortgage Quote and Best Mortgage Rates, call an Ellisons Mortgage Advisor on 020 8944 9494



Although these particulars are believed to be correct, their accuracy is not guaranteed and they do not form part of any contract.

Celebrating 30 years of successful Sales and Lettings in Merton

